

Please rate this document after reviewing at the bottom of this page.

COMPONENT

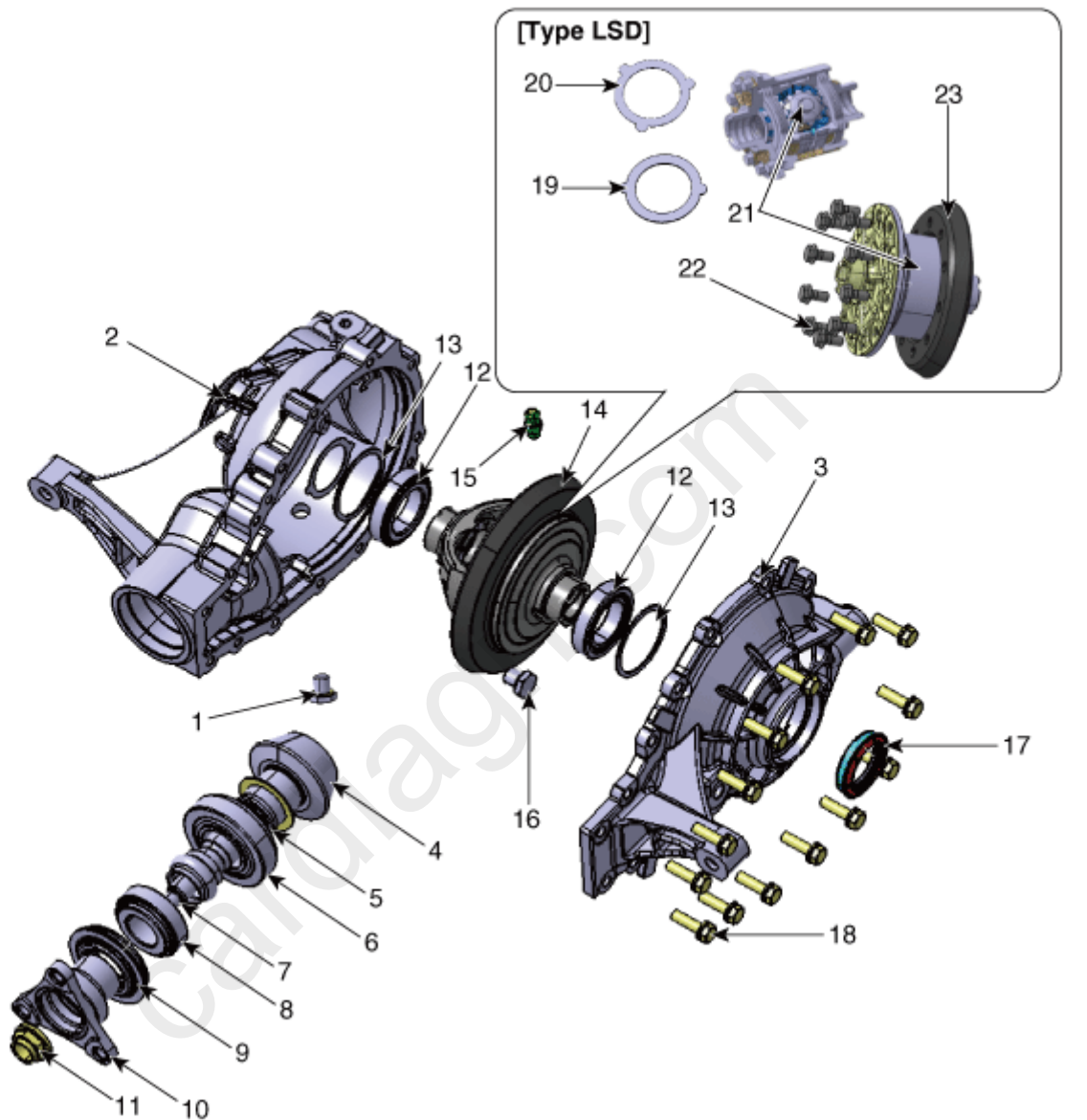

- | | | |
|--------------------------------------|--------------------------------------|--------------------------------------|
| 1. Drain plug | 9. Pinion oil seal | 17. Side oil seal |
| 2. Differential case | 10. Companion flange | 18. Differential case cover bolts |
| 3. Differential cover | 11. Pinion lock nut | 19. Oil guide spacer (RH) |
| 4. Pinion drive gear | 12. Differential side bearing | 20. Oil guide spacer (LH) |
| 5. Pinion drive gear adjustment shim | 13. Differential side bearing spacer | 21. LSD |
| 6. Pinion rear bearing | 14. Differential case assembly | 22. Differential case assembly bolts |
| 7. Pinion bearing spacer | 15. Air breather | 23. Drive gear |
| 8. Pinion front bearing | 16. Filler plug | |

* Thanks for your cooperation for the more quality. Please surely rate this document before closing.